

Elevation B

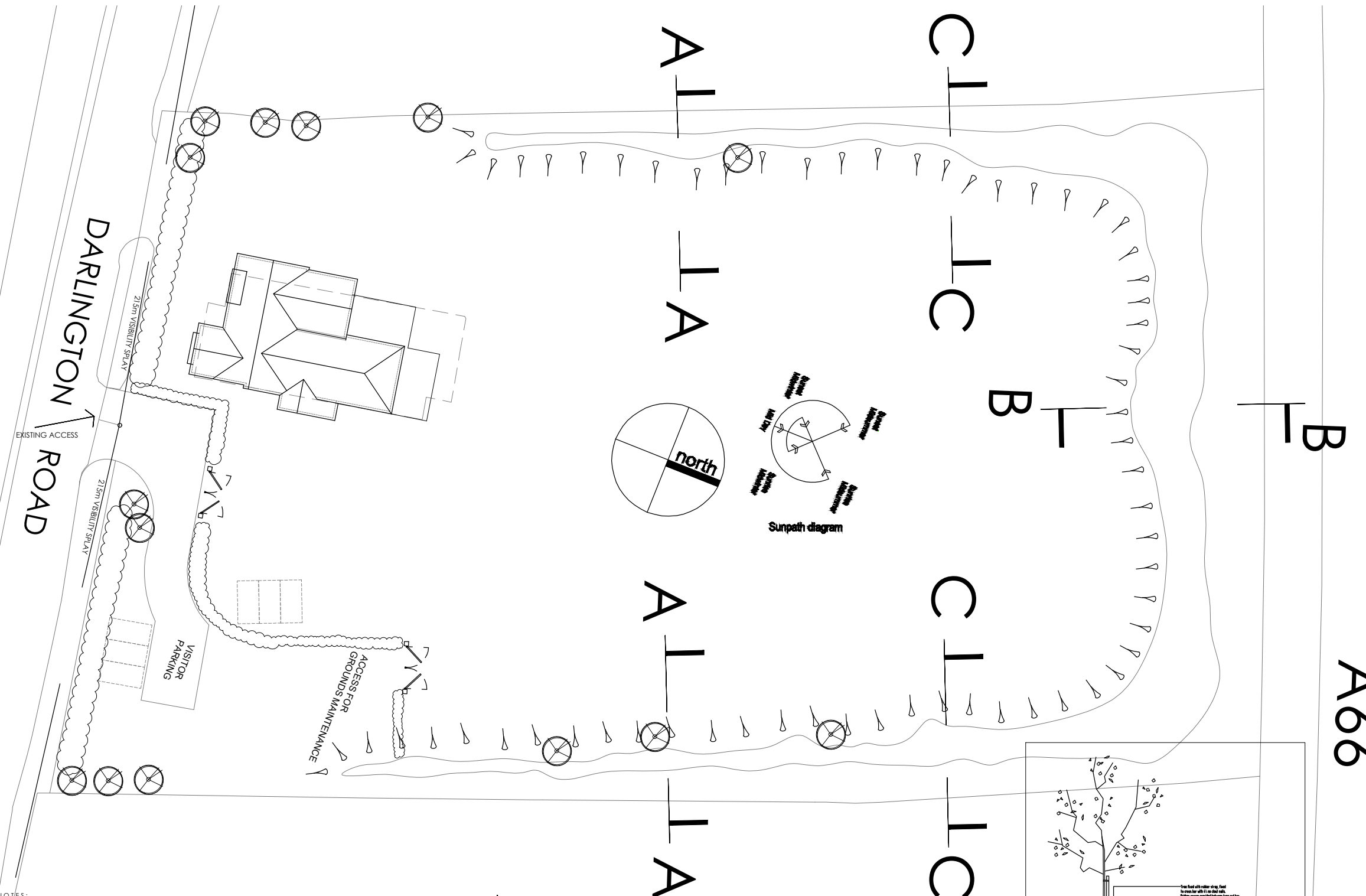

**CULTIVATIONS AND PLANTING**

Tree and Shrub Planting - Planting Pits

a) Excavate tree pits as follows:-  
Std. HS, EHS trees, 1000x1000x1000mm deep  
b) Loosen base to a further depth of 200mm and scarify sides. Dispose of unsuitable excavated material off site to approved tip.  
c) Tree stakes to be pressure treated, minimum diameter 65mm and painted at one end. Stakes to be driven into the pit before planting to a minimum depth of 300mm below the base of the pit.

Std. HS, EHS trees, Double Staked  
Feathered - Single staked

d) Tree or transplant to be planted in pit to a depth and orientation related to the original growing position in the nursery and backfilled with the excavated topsoil mixed with approved tree and shrub planting compost in the following amounts:-  
Std. HS, EHS trees, 80 litres/tree  
Feathered 50 litres/tree  
Transplants 4 litres/transplant

e) Trees to be tied to the supporting stakes with adjustable reinforced rubber tree ties with solid rubber spacers, positioned at an approved point suitable to the habit of the tree.

f) Water to be applied to all trees and transplants on the same day as planting:-  
Std. HS, EHS trees, 30 litres/tree  
Feathered 18 litres/tree  
Transplants 5 litres/transplant

**PLANTING AREAS**

**Weed Control**

a) Keep areas around trees and transplants free from annual and perennial weeds by hand weeding. All arisings to be removed from site.  
Allow 7 no. visits per year.

b) Apply translocated herbicide to a 1.0m. dia around each transplant and tree or as directed by Landscape Designer.  
Allow 3 no. visits per year.

**Mulch**

a) Bark mulch to be reinstated to original depths at the end of each growing season.

**Watering**

a) All planting shall be watered with a low pressure hose during dry spells within the first year only at the following rates:  
Std. HS, EHS trees, 30 litres/tree/visit  
Feathereds 18 litres/tree/visit  
Shrubs/transplants - 5 litres/visit

**Fertiliser**

a) At the end of the establishment period, 30gms of slow release fertiliser to be applied around each plant.  
Allow 1no. visit at end of Year 2.

**Firming in**

a) All plants and tree stakes loosened by planting operations. wind or frost shall be firmed in.  
Allow 1no. visit per year.

**Litter Collection**

a) Whole site to be kept in a clean and tidy conditions throughout the establishment period. Litter to be removed from site.  
Allow 20 no. visits per year.

**MAINTENANCE - SOFT LANDSCAPE**

**General**

a) The Contractor shall be responsible for the maintenance of the planting areas for a sixty month period following the completion of the works and will be responsible for any defects due to faulty materials, including plant failures, or workmanship during this time.

b) The Contractor shall carry out maintenance work at suitable intervals and in suitable weather conditions.

c) 48 hours notice in writing shall be given before commencement of any maintenance operations. Failure to do so will result in non payment for any supposed work carried out.

**Defects Liability Period**

a) Any trees and transplants, found to be defective or missing for any reason before practical completion shall be replaced by the Contractor entirely at his own expense.

b) Thereafter any failures within sixty months of the date of practical completion shall also be replaced to the original specification by the Contractor entirely at his own expense.

**GENERAL NOTES**

**Plant Sourcing and Handling**

All plants shall be of a native source grown in the UK. Wherever possible, plants will have been grown from seed, cutting or root stock of a local provenance. Plants and trees shall comply with BS 3936, being healthy, vigorous, bushy plants with a fibrous, well rooted system that is in proportion to the size of the plant. Planting shall be in accordance with BS 4428.

**Seeding**

All areas of placed sub/topsoil within the site which are not planted or surfaced will be seeded with a low maintenance wildflower weed mix such as British Seed Houses A22 Mix or equivalent approved.

**Planting Preparation**

Topsoil depths are to be a minimum of 300mm for planted areas and 150mm for seeded areas. It is unlikely that topsoil will need to be imported, however, if necessary it will comply to BS 3882:1994. Notch planting will generally be used for bare root transplants. Pit planting will be used for rootballed, container grown, feathered stock and standard trees. The preparation of planting pits will comply with BS 4428 and BS 5837 and will not take place when the ground is either frozen or waterlogged.

**Rubbish and Debris**

A certain amount of litter, debris and redundant objects have accumulated around the site. Where possible this should be removed from site or buried locally. All litter is to be removed from site and recycled where possible.

**Maintenance**

All planting will be maintained in such a way as to exclude competitive plants. Any herbicides will be used with care to avoid spray drift damage. All trees and shrubs will be maintained in a firm upright growing position and all dead wood, diseased tissue, suckers and epicormic growth will be removed from all plants at the end of each growing season. All planting shall be maintained and dead or dying material shall be replaced for a period of five years from the agreed date of planting to the satisfaction of the LPA.

**Implementation**

Structural landscaping to be implemented within first planting/seedling season following commencement. Garden landscaping to be implemented in first planting season following occupation of building or completion of development whichever is sooner.

**Replacements**

Any trees, shrubs or hedges planted in accordance with these proposals which are removed, die, become severely damaged or become seriously diseased within five years of planting shall be replaced within the next planting season by trees, shrubs or hedging plants of similar size and species to those originally required to be planted.

**SPECIFICATION**

**PLANTING SPECIFICATION**

All work and materials shall be in accordance with current British Standards Components and to Code of Practice.

**SITE CLEARANCE**

a) Remove general builders rubble, rubbish and the like from the areas to be planted. Such materials to be collected and taken to Contractors tip or disposed of on site as directed.

b) Approved translocated herbicide to be applied to planting area.

**EARTHWORKS (if not supplied by Main Contractor)**

a) Areas for transplants to be ripped with fixed lines at 500mm centres to a depth of 500mm in two directions at 90 degrees to each other to the Employers satisfaction.

**Transplant Areas**

It is assumed that the existing topsoil will be suitable for re-use, if this is not the case then the Contractor should provide a rate for the supply of approved topsoil.

- NOTES:**
- DO NOT SCALE FROM THIS DRAWING.
- This drawing is copyright of sjd Architects Ltd. No part of this drawing may be reproduced in any material form without the written permission of sjd Architects Ltd. WARNING: the doing of an unauthorised act in relation to a copyright work may result in both a civil claim for damages and criminal prosecution.
  - All dimensions to be verified on site prior to any shop or site works being commenced.
  - Any discrepancies to be reported to the Architect BEFORE any work is put in hand.
  - This drawing must be read in conjunction with relevant consultants and specialists drawings.
  - This drawing must be read in conjunction with the drawings specified.
  - sjd Architects Ltd accepts no liability to third parties arising out of the unlawful reproduction or use of this drawing.

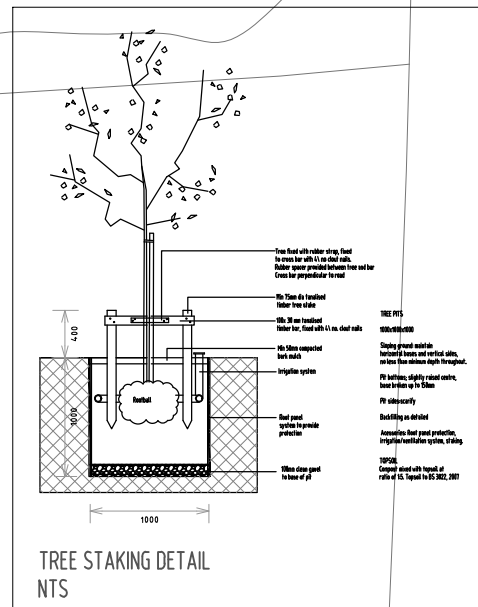
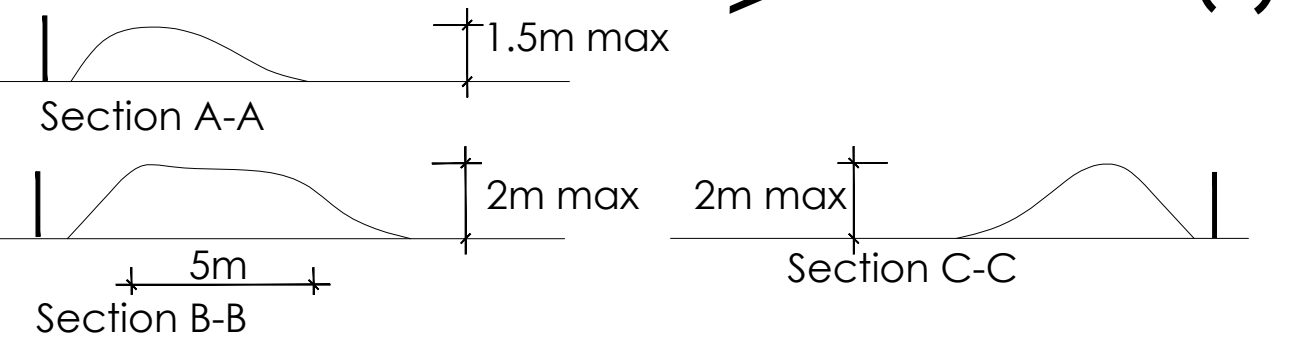

A666

Species	Mix	Strs	Condition
<i>Corylus avellana</i>	5%	60-80cm	B
<i>Crataegus monogyna</i>	60%	60-80cm	B
<i>Ilex aquifolium</i>	15%	50-60cm	2L
<i>Prunus avium</i>	5%	60-80cm	B
<i>Prunus spinosa</i>	5%	60-80cm	B
<i>Rosa canina</i>	5%	60-80cm	B
<i>Sambucus nigra</i>	5%	60-80cm	B

Above to be planted in species groups of varying sizes between 5no and 10no at a rate of 5 per linear metre in double staggered row 30cm apart for lengths of new native hedgerow and to gap up existing where necessary or as indicated on plan.

A 09-05-22 DWELLING FOOTPRINT REDUCED  
REV DATE DETAILS

**sjd Architects Ltd**  
Tanners Bank Design Studio  
Aislaby Road  
Egglecliffe  
Stockton-on-Tees  
TS16 0JJ

01642 780129  
sjdach@btconnect.com  
www.sjdarchitects.co.uk

**sjd**  
ARCHITECTS

CLIENT: 1988-21  
PROJECT: FORMER SUITON ARMS ELTON  
DRAWING TITLE: PROPOSED EXTERNAL WORKS & TYPICAL SITE SECTION  
PURPOSE OF ISSUE: **PLANNING**  
SCALE: 1:400 @ A3 1:200 @ A1  
DATE: AUG 21  
DRAWN BY: sjd  
DRAWING NO: 1988-21-104